

Lake St. Clair Schedule C1

Legend

Settlement Areas	Maintenance Holes	Watermains
Downtowns	Water Treatment Plant	Gravity Mains
Chatham - Kent Boundary	Raw Water Pumping Station	Force mains
Parcels	Control and Metering System	
Railway	Water Reservoir	
Local Roads	Raw Water Intake	
Collector Roads	Elevated Treated Water Storage Tower	
Arterial Roads	Municipal Wells	
Provincial Highway	Booster Pumping Station/Pumphouse	
	WPCPs and Lagoons	

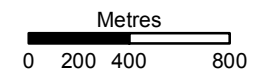

Disclaimer: The Municipality of Chatham-Kent takes every precaution to put up-to-date and correct information on all maps published by Corporate Applications. However, it does not expressly warranty that the information contained in the map is accurate on the date of publication. All users may use this information at their own risk. The municipality will not entertain any claims arising out of the use of this map or information

MUNICIPALITY OF CHATHAM - KENT LAKE ST. CLAIR SCHEDULE



C1 INFRASTRUCTURE

With the support of the Federal Economic Development Agency for Southern Ontario



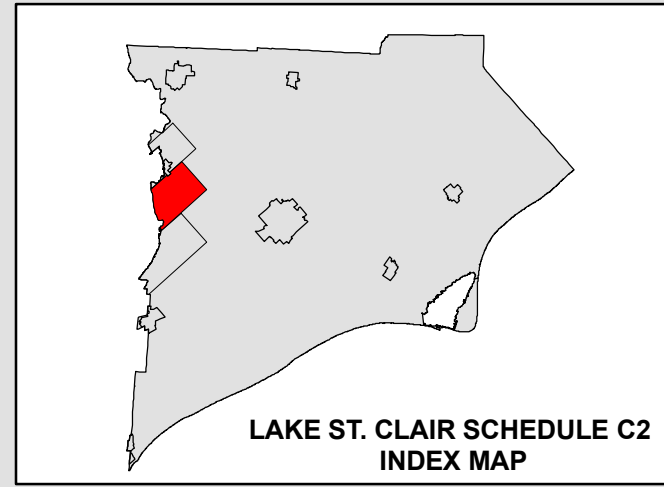
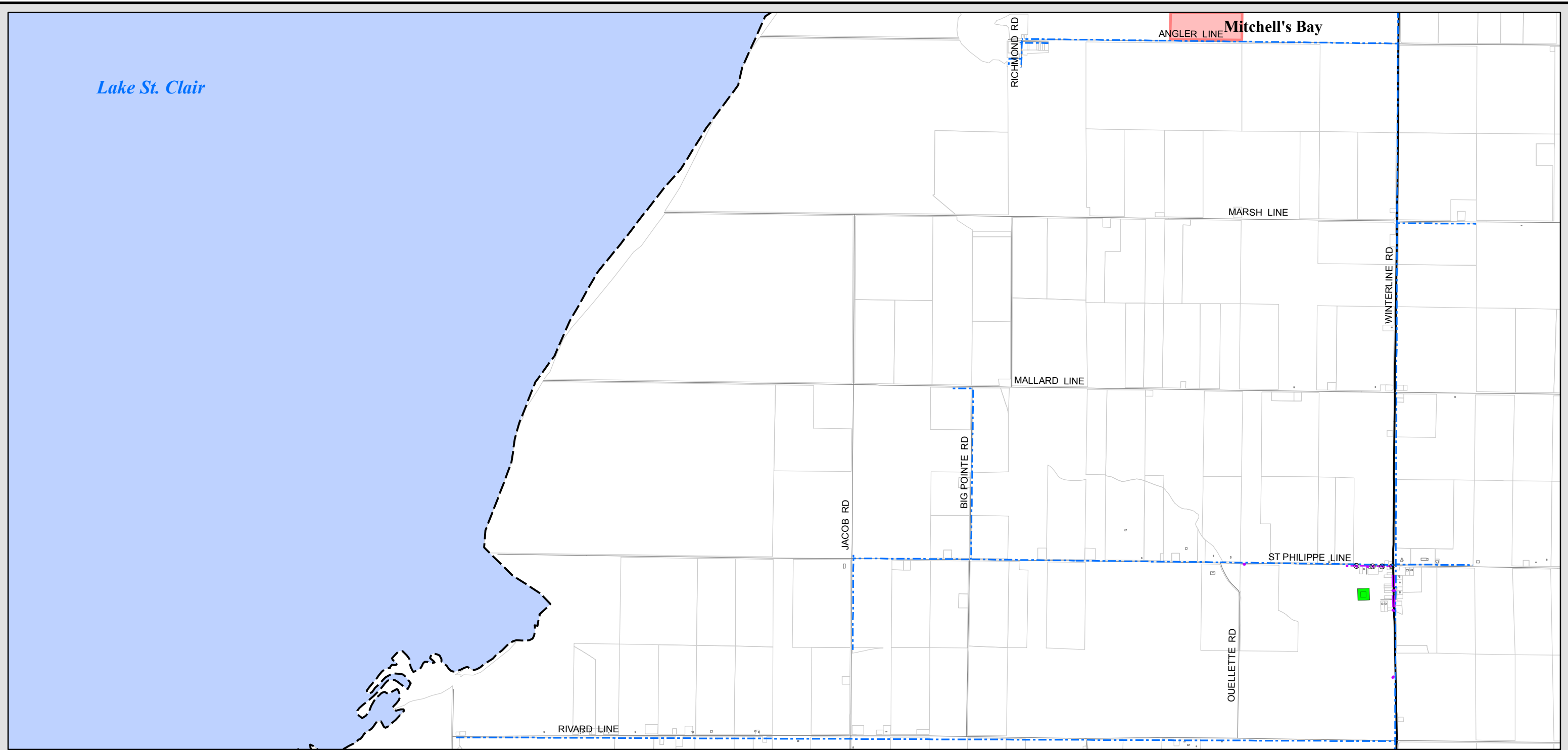

Lake St. Clair Schedule C2

Legend

- | | | |
|-------------------------|--------------------------------------|---------------|
| Settlement Areas | Maintenance Holes | Watermains |
| Downtowns | Water Treatment Plant | Gravity Mains |
| Chatham - Kent Boundary | Raw Water Pumping Station | Forcemains |
| Parcels | Control and Metering System | |
| Railway | Water Reservoir | |
| Local Roads | Raw Water Intake | |
| Collector Roads | Elevated Treated Water Storage Tower | |
| Arterial Roads | Municipal Wells | |
| Provincial Highway | Booster Pumping Station/Pumphouse | |
| | WPCPs and Lagoons | |

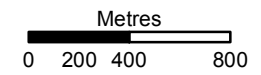

Disclaimer: The Municipality of Chatham-Kent takes every precaution to put up-to-date and correct information on all maps published by Corporate Applications. However, it does not expressly warranty that the information contained in the map is accurate on the date of publication. All users may use this information at their own risk. The municipality will not entertain any claims arising out of the use of this map or information

**MUNICIPALITY OF CHATHAM - KENT
LAKE ST. CLAIR SCHEDULE**



**C2
INFRASTRUCTURE**

With the support of the Federal Economic Development Agency for Southern Ontario



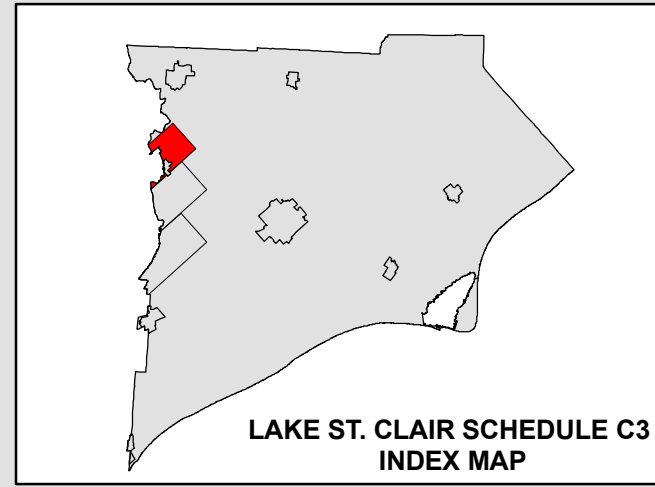
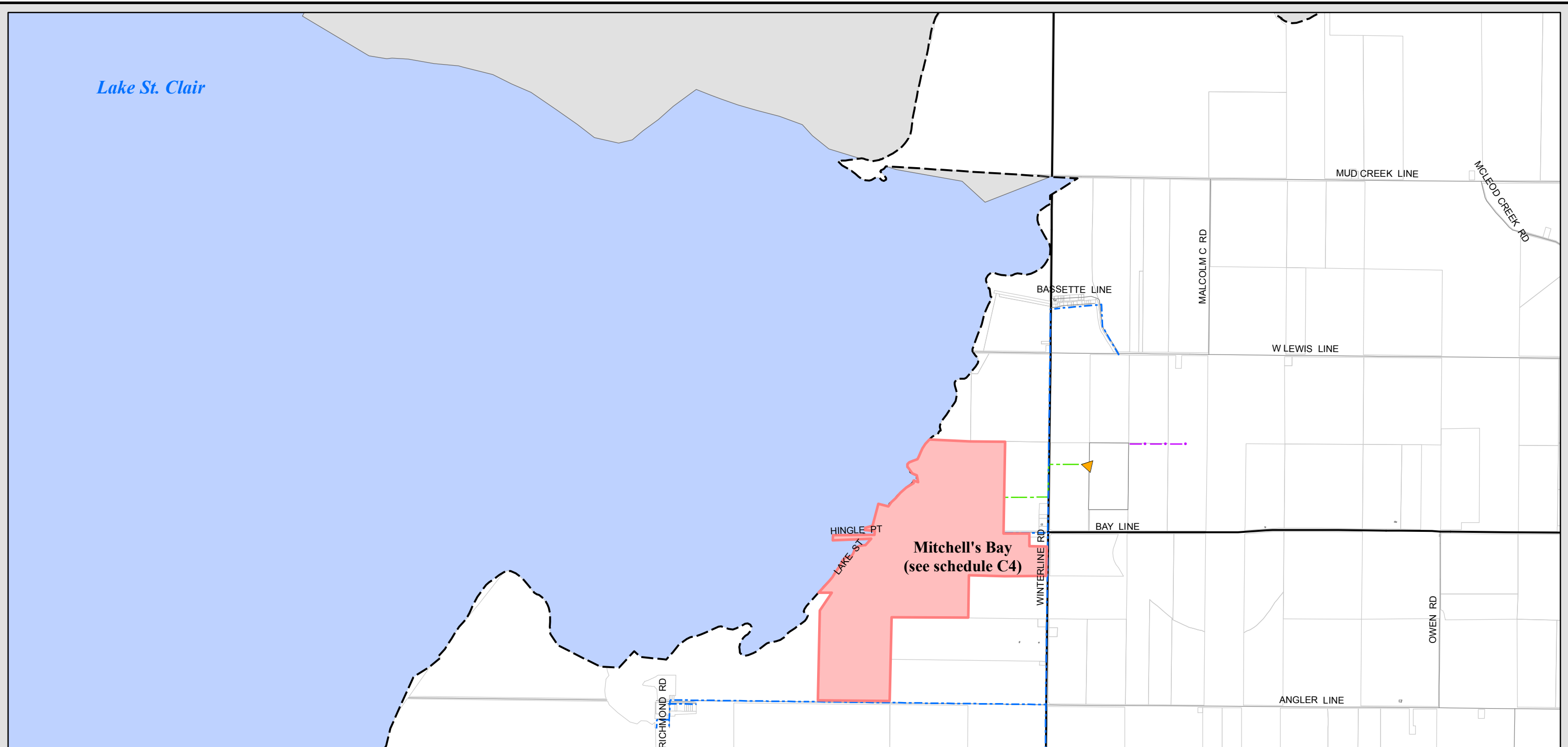

Lake St. Clair Schedule C3

Legend

- | | | |
|-------------------------|--------------------------------------|---------------|
| Settlement Areas | Maintenance Holes | Watermains |
| Downtowns | Water Treatment Plant | Gravity Mains |
| Chatham - Kent Boundary | Raw Water Pumping Station | Forcemains |
| Parcels | Control and Metering System | |
| Railway | Water Reservoir | |
| Local Roads | Raw Water Intake | |
| Collector Roads | Elevated Treated Water Storage Tower | |
| Arterial Roads | Municipal Wells | |
| Provincial Highway | Booster Pumping Station/Pumphouse | |
| | WPCPs and Lagoons | |

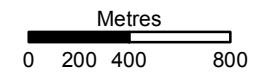

Disclaimer: The Municipality of Chatham-Kent takes every precaution to put up-to-date and correct information on all maps published by Corporate Applications. However, it does not expressly warranty that the information contained in the map is accurate on the date of publication. All users may use this information at their own risk. The municipality will not entertain any claims arising out of the use of this map or information

**MUNICIPALITY OF CHATHAM - KENT
LAKE ST. CLAIR SCHEDULE**



**C3
INFRASTRUCTURE**

With the support of the Federal Economic Development Agency for Southern Ontario



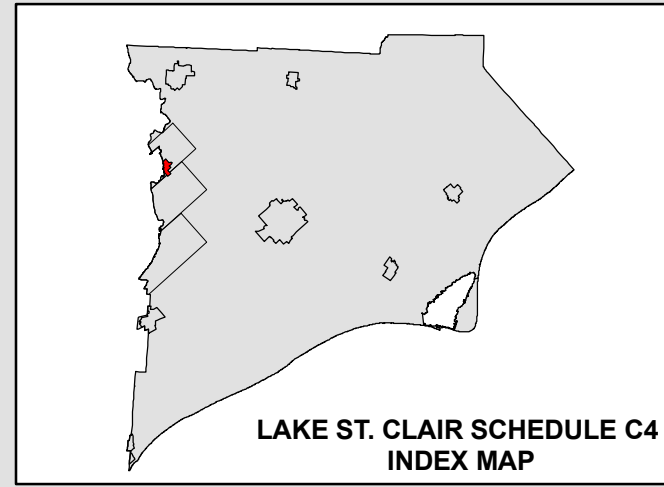
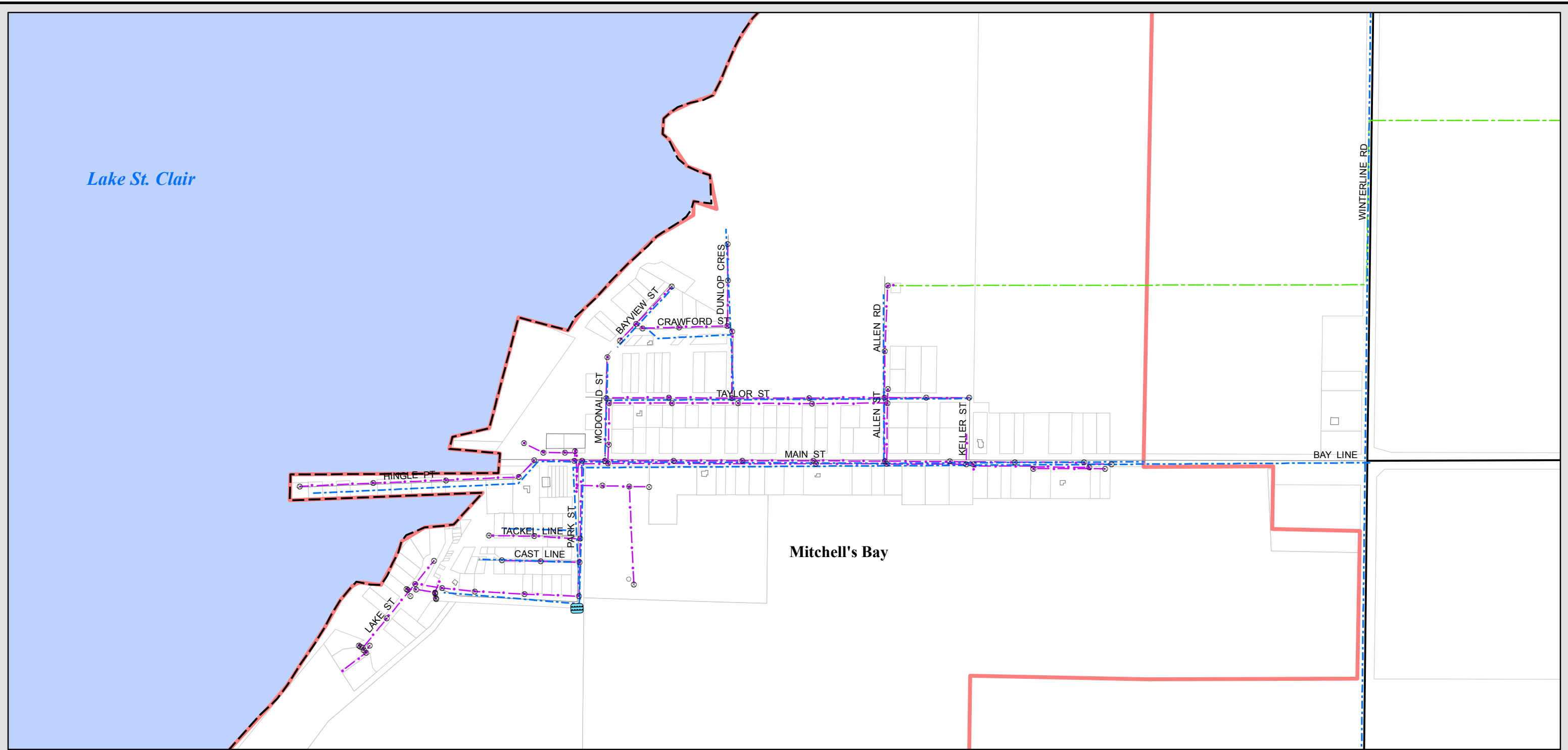

Lake St. Clair Schedule C4

Legend

- | | | |
|-------------------------|--------------------------------------|---------------|
| Settlement Areas | Maintenance Holes | Watermains |
| Downtowns | Water Treatment Plant | Gravity Mains |
| Chatham - Kent Boundary | Raw Water Pumping Station | Forcemains |
| Parcels | Control and Metering System | |
| Railway | Water Reservoir | |
| Local Roads | Raw Water Intake | |
| Collector Roads | Elevated Treated Water Storage Tower | |
| Arterial Roads | Municipal Wells | |
| Provincial Highway | Booster Pumping Station/Pumphouse | |
| | WPCPs and Lagoons | |

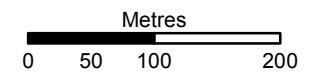

Disclaimer: The Municipality of Chatham-Kent takes every precaution to put up-to-date and correct information on all maps published by Corporate Applications. However, it does not expressly warranty that the information contained in the map is accurate on the date of publication. All users may use this information at their own risk. The municipality will not entertain any claims arising out of the use of this map or information

**MUNICIPALITY OF CHATHAM - KENT
LAKE ST. CLAIR SCHEDULE**



**C4
MITCHELL BAY
INFRASTRUCTURE**

*With the support of the Federal Economic Development Agency
for Southern Ontario*

